

*'Sometimes I think
my head is so big because
it is so full of dreams.'*

THE ELEPHANT MAN

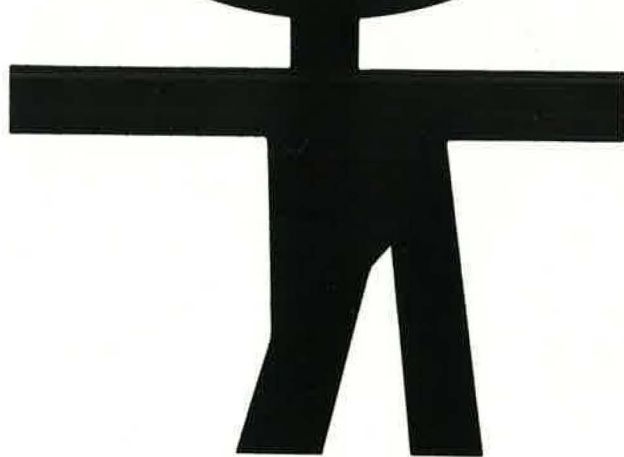

Theatre Three

TWENTIETH ANNIVERSARY SEASON

Knowing what to build is important.

It takes more than steel and concrete to make a great city. It takes people and organizations that realize the importance of the arts.

And the value of keeping them alive and vigorous. For nearly a century.

The Dallas Morning News has shared a love for the arts with the people of Dallas. And today, through in-depth coverage and reviews as well as direct underwriting and sponsorship, we continue to give the arts support. Because we believe that for a city to thrive, it must have a strong cultural foundation.

The Dallas Morning News
That extra edge

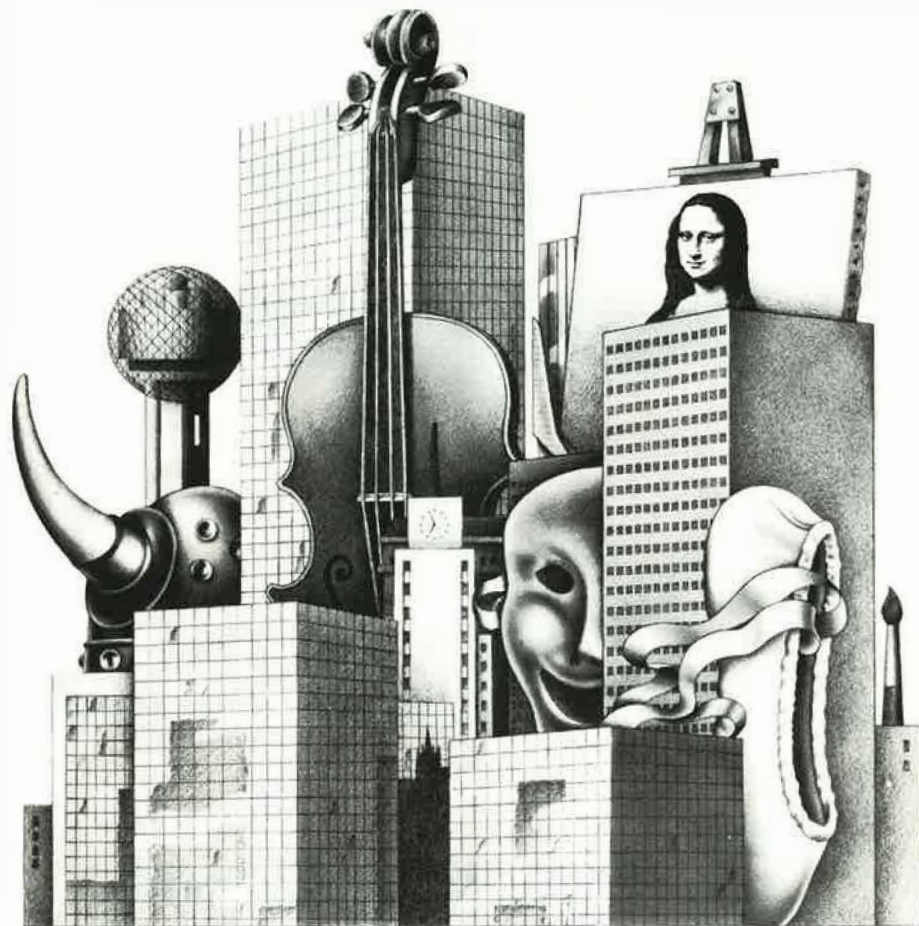

The Dallas Morning News salutes Theatre Three.

Mobil Foundation, Inc.

... thanks Theatre Three's board of directors, staff and patrons for letting Mobil play a positive role in making "The Elephant Man" possible.

All of us at Mobil are pleased to be a part of the excellent entertainment that Theatre Three is bringing to the people of Dallas.

Mobil

Theatre Three is deeply grateful to the following individuals, foundations and corporations who have made significant financial contributions to the theatre during the past twelve months:

ANGELS

Atlantic Richfield Foundation
(ARCO Oil & Gas Company,
Division of Atlantic Richfield Co.)
The 500, Inc.
Meadows Foundation

PRODUCERS

Bette Clair McMurray Foundation
Dallas Clearing House Association:
American Bank & Trust Co.
Bank of Dallas
Bank of the Southwest
Bank of Texas
Brookhollow National Bank
Capital Bank
Cullen/Frost Bank of Dallas
Dallas International Bank
Dallas Natl. Bank in Dallas
Empire Bank of Dallas
Equitable Bank
First Citizens Bank
First City Bank of Dallas
First City Bank-Market Center
First National Bank in Dallas
Grand Avenue Bank
Greenville Avenue Bank & Trust
Grove State Bank
Hillcrest State Bank
Inwood National Bank of Dallas
Lakewood Bank & Trust Co.
Liberty National Bank
Lincoln Centre Bank
Love Field National Bank
Mercantile Natl. Bank at Dallas
Metro Bank of Dallas
Natl. Bank of Commerce of Dallas
NorthPark Natl. Bank of Dallas
Oak Cliff Bank & Trust Co.
Pan American Natl. Bank of Dallas
Park Cities Bank
Preston State Bank
Prestonwood National Bank
Republic National Bank of Dallas
ReUnion Bank
Texas American Bank
Texas Commerce Bank—Campbell Centre
Texas Commerce Bank—Casa Linda
Texas Commerce Bank—Dallas
Texas Commerce Bank—Northwest
Texas Commerce Bank—Park Central
Texas Commerce Bank—Preston Royal
Trinity National Bank of Dallas
Valley View Bank
White Rock Bank of Dallas
Wynnewood Bank & Trust
Dallas County, Dept. of Planning
Research and Grants
Dallas Park and Recreation Board
Dresser Industries, Inc.
Earth Resources Company
Gulf Oil Corporation
Mrs. Eugene McDermott
Mobil Foundation, Inc.
Rockwell International
Stallworth Oil & Gas Co.
TACA, Inc.
Target Stores
Arthur Young & Co.

BENEFACTORS

American Petrofina Foundation
Arthur Andersen & Co.
Ben E. Keith Co.
Mr. & Mrs. Curtis E. Calder, Jr.
Mr. & Mrs. John P. Castleman, Jr.
Celanese Chemical Co., Inc.
Chaparral Steel Company
Core Laboratories, Inc.
Mr. & Mrs. O. Paul Corley
Dallas Times Herald
Mr. & Mrs. Dwight L. Hunter, Jr.
Edwin B. Jordan
Lomas & Nettleton Financial Corp.
Harry S. Moss Foundation
National Gypsum Company
Neiman-Marcus
Peat, Marwick, Mitchell & Co.
Billy Rose Foundation, Inc.
Mr. & Mrs. L. J. Scott
Mr. & Mrs. Charles S. Sharp
Mr. & Mrs. Marvin S. Sloman
Sun Gas Company
Sun Production Company
Sunmark Exploration Co.
Sunoco Energy Development Co.
Texas Commission on the Arts
Tyler Corporation
Mr. & Mrs. Toddie Lee Wynne, Jr.

PATRONS

Allstate Foundation
Norman E. Brinker
Dallas Diagnostic Association
Mr. & Mrs. John W. Dayton
Early Foundation, Inc.
Gifford-Hill & Co.
Halliburton Company
Mr. & Mrs. W. Franklin Kepler
Mr. & Mrs. Charles S. McKamy
Sanger Harris
Mr. & Mrs. Rex A. Sebastian
Mr. & Mrs. Morris G. Spencer
World Producers, Inc.

SPONSORS

Austin Industries, Inc.
Charles R. Bailley
Bozell & Jacobs, Inc.
Braewood Development Corp.
Contran Corporation
Dr Pepper Company
Randolph F. Duggan, Jr.
Lee Faulkner
First Texas Savings Association
Mrs. Sidney E. Goldman
Helen Graham, M.D.
Mr. & Mrs. William W. Jagoda
Mrs. B. C. Jefferson
Lifson, Herrmann, Blackmarr & Harris
Liquid Paper Corporation
David G. Luther
Noel, Greaves and Strother
W. W. Overton, Jr.
Mr. & Mrs. Robert R. Penn
Dr. & Mrs. Laurence Perrine
Mr. & Mrs. Charles "Bo" Price
Republic Financial Services, Inc.
Mr. & Mrs. George J. Reuter

Mrs. George R. Russell
... in memory of
George R. Russell
Louis J. Sandbote, P.C.
Mr. & Mrs. Loyd B. Sands
Sally A. Schreiber
Lee M. Simpson
The Southland Corporation
Southwestern Bell Telephone Co.
Mr. & Mrs. Nelson H. Spencer
Waldo E. Stewart
Sun Information Services Co.
Mr. & Mrs. George R. Truitt
Martha C. West
Mr. & Mrs. Frederic F. Wiedemann
Wiener Lumber Company

DONORS

Mr. & Mrs. James K. Appleton
Mr. & Mrs. William P. Barnes
Christine L. Barton
Batteries Unlimited, Inc.
Mrs. Eugene E. Beatty
Dr. & Mrs. Arno H. Beuther
Gene H. Bishop
Mr. & Mrs. Irving H. Bloch
Bollen & Associates
Mr. & Mrs. Malcolm K. Brachman
Sheila Burke Designs
Dr. & Mrs. James B. Clayton
Dr. & Mrs. E. E. Clinton
Col. & Mrs. Howard B. Coffman, Jr.
Mr. & Mrs. James F. Cole
Mrs. Calvert K. Collins
Cooper Airmotive
Mr. & Mrs. L. E. Creel, III
Cullum Construction Co., Inc.
Oliver H. Daniel
Cynthia Davis
Darr Equipment Company
Dr. & Mrs. J. B. Doak
Lucy Dulin, CLU
Mr. & Mrs. E. E. Fogelson
The Rev. James M. Frenslay
Mr. & Mrs. R. R. Gilbert, Jr.
Henry Gilchrist
Dr. & Mrs. M. S. Ginsburg
Mr. & Mrs. Patterson B. Glass
Mr. & Mrs. Felix B. Goldman
Mr. & Mrs. C. W. Goldner, Jr.
Mr. & Mrs. Leonard M. Green
Mr. & Mrs. Dean P. Guerin
T. J. Hansen Co.
Mr. & Mrs. Terrell R. Harper
Mr. & Mrs. Jack W. Hawkins
Dr. & Mrs. David Haymes
Edmund M. Hoffman
Mr. & Mrs. Seymour G. Hootkins
The Horchow Collection
Dr. Jackie Hansen Hunt
Mr. & Mrs. Irvin J. Jaffe
Dr. Mary W. John
Dr. & Mrs. Sydney R. Jones, III
Mrs. Laurence S. Kahn
Liberty Steel Company
Linbeck Construction Company
Lester L. Logue
Mr. & Mrs. Irving Manney

(DONORS CONT.)

Marsh & McLennan, Inc.
Mary Kay Cosmetics, Inc.
W. A. McKenzie, Jr. (Shreveport)
Mrs. Zula H. McMillan
Ms. Renie Mead
Mr. & Mrs. George Miller
Mr. & Mrs. Henry S. Miller, Jr.
Mr. & Mrs. John B. Mills
Dr. & Mrs. Neil R. Morrow
Mr. & Mrs. William Oncken, Jr.
Dr. & Mrs. Allen K. Pearlman
Dr. & Mrs. A. S. Plotkin
Dr. & Mrs. Ralph F. Rashbaum
The Richards Group
Dr. & Mrs. E. R. Richardson
Mr. & Mrs. Jules J. Ringer
Mr. & Mrs. John H. Rowley
Mr. & Mrs. Frank M. Ryburn, Jr.

Mr. & Mrs. William B. Sechrest
Roy G. Sheldon
Mr. & Mrs. A. H. Silberberg
Smith Barney, Harris Upham & Co.
Susan K. Snuggs
Mr. & Mrs. William T. Solomon
Mr. & Mrs. Donald J. Stone
Summit Energy, Inc.
Mr. & Mrs. E. J. Toomey
Tracy-Locke Advertising
Mrs. William E. Tweed
Mr. & Mrs. I. A. Victor
Viola Commercial Cleaning Supplies
Joe H. Warren, Jr.
Mr. & Mrs. James W. Watson
Mr. & Mrs. Virgil F. Webb
Edith Wells
Mrs. W. J. Wilkie

Theatre Three appreciates the goodwill of the following firms and individuals who have helped to keep down the operating expenses of the theatre:

Kelly Anderson
Terry Book, Asst. Professor—
Manager of TV Facilities,
Broadcast/Film Arts Div.,
Meadows School of the Arts, SMU
Ben E. Keith Co.
City Arts Program and Office
of Human Development,
City of Dallas
Clampitt Paper Company
Dallas Historical Society
Dean Corbitt
Design Resource Group
E. J. Hair Company
Doug Frazier,
Ace Hardware, Lakewood
Andy Hanson
KDFW-TV
LEE Distributing Co.
Monarch Paper Company
Brook Mays Music Co.
Barbara Murrell
Quadrangle Associates
Summit Sales Co.
TDF Systems
UTD
Arthur Young & Company

THEATRE THREE BOARD OF DIRECTORS

Mr. & Mrs. Marvin S. Sloman, Chairmen
Miss Norma Young, Honorary Member
Mr. Jac Alder, Producer-Director
Mr. & Mrs. Jim C. Averitt
Mr. & Mrs. Curtis E. Calder, Jr.
Mrs. Stephen H. Casey
Mr. & Mrs. John P. Castleman
(Leave of absence)
Mr. & Mrs. Sam L. Catter
Mr. & Mrs. Virgil W. Coopridge
Mr. & Mrs. O. Paul Corley
Mr. & Mrs. Richard Counts
Mr. & Mrs. Edgar C. Hughes
Mr. & Mrs. W. Franklin Kepler
Mr. & Mrs. Dan M. Krausse
Mr. & Mrs. Warner H. Lewis
Mr. & Mrs. Ian R. Marcil
Mr. & Mrs. Thomas R. McCartin
Mr. & Mrs. Rex A. Sebastian
Mr. & Mrs. Robert B. Stallworth, Jr.
Mrs. William E. Tweed
Mr. & Mrs. Jack L. Vandagriff
Mr. & Mrs. John Washburn
(Liaisons-The 500, Inc.)
Mr. Charles S. Werner
Mrs. Gwynne Wilson
Mr. & Mrs. John D. Wisenbaker
Mr. & Mrs. Paul J. Zuccori

THE STAGE LIGHTING

The Stage Lighting System At Theatre Three
Has been Made Possible By Generous Grants From:
ATLANTIC RICHFIELD FOUNDATION
BELO BROADCASTING CORPORATION
HOBLITZELLE FOUNDATION

Theatre Three was founded in 1960 by Norma Young, who served as the Artistic Director through 1976.

YOU can play a part . . .

- ☐ \$25,000 - over **Angel**
- ☐ \$5,000 - \$24,999 **Producer**
- ☐ \$1,000 - \$4,999 **Benefactor**
- ☐ \$ 500 - \$ 999 **Patron**
- ☐ \$ 250 - \$ 499 **Sponsor**
- ☐ \$ 100 - \$ 249 **Donor**
- ☐ under \$ 100 **Contributor**

Amount: \$ _____
Any donation over \$100 will be listed in Theatre Three playbills during the coming season. All contributions to Theatre Three are tax-deductible.

This contribution is:
☐ Company ☐ Personal
☐ Check here if you wish your contribution to remain unlisted.

Your Annual Investment in Dallas' Theatre Three is Tax Deductible.

Dallas' Theatre Three

Attn: Development Office
2800 Routh, Dallas, Texas 75201
Telephone: 651-7225

☐ Check Enclosed
(Payable to Theatre Three, Inc.)

☐ Please bill me.

NAME _____

COMPANY _____

ADDRESS _____

CITY _____ ZIP _____

HOME PHONE _____ OFFICE _____

This Playbill has been provided by a generous grant from TACA, INC.



DARK INHERITANCE

BY RENICE McGARRITY

JUNE 16 - JULY 25
PREVIEWS: JUNE 12 - 14

Presented by

**new
arts
theatre
company**
west end

702 Ross Ave at Market
Dallas, Texas 75202
(214) 761-9064

Enhance your home
with living plants . . .
we select only quality,
specimen tropicals for
the discerning
homeowner . . . each in-
stallation personalized
to meet your needs . . .
choose from an in-
teresting assortment of
containers . . . for sale or
lease . . . residential or
commercial . . . design, con-
sultation, maintenance, de-
livery and installation.

Call the professionals . . .



**ADAM
WHITNEY**
interior plants

1616 Oak Lawn Ave. • Dallas, TX. 75207
(214) 651-1199

**Our commitment
to Dallas' future
is a remembrance
of its past.**



Theatre Three presents

THE ELEPHANT MAN

BY BERNARD POMERANCE

Featuring
(in alphabetical order)

JOHN STUART ANDERSON
SHARON BUNN
NED BUTIKOFER
PETER CHANNELL

VINCE DAVIS
TOM FERSTLE
MIKE HARRELL
LAURENCE O'DWYER

ANNIE STAFFORD

Produced by
JAC ALDER

Set Design by
PETER A. METZ

Lighting by
SHARI MELDE

Directed by
CHARLES HOWARD

Costumes by
PATTY GREER MCGARITY

Cellist
YVES L'HELGOUAL'CH

Model of St. Philip's Church by
HARLAND WRIGHT

Stage Manager — Tom Schilling

Assistant Stage Managers — Keith Allgeier, Mary Cabello

Movement Consultant — Betsy Thornton

Set and Light Crew — Deborah Brooks, Bill Campbell, Brian Denny, Bob Golibart, Amy Mills, Dan Perry, Michael Van Dalsem, Willie Woods

Wardrobe Mistress — Peggy Kruger

Costume Crew — Julie Dale, Peggy Kruger, Amy Mills, Laurel Nelson, Michael Van Dalsem

Hair Design — Michael Van Dalsem

Mobil

Sets and costumes provided by
Mobil Foundation, Inc.

Sutherlands
A BRASSERIE

Serving food and drink from
11 a.m. til 2 a.m.

2911 Routh at Cedar Springs
Dallas, Texas 75219

214/698-0034

Dallas' premiere
foreign and art film
theatre.

THE S HOWCASE

VALLEY VIEW AT JOSEY LN. 241-2410

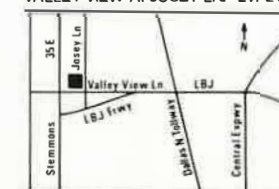

Call for
current features
and times
1st Show Daily
\$2.00

THE CAST

Frederick Treves.....✓LAURENCE O'DWYER
 Belgian Policeman
 Carr Gomm.....✓JOHN STUART ANDERSON
 Conductor
 Ross.....✓MIKE HARRELL
 Bishop Walsham How
 Snork
 John Merrick.....✓VINCE DAVIS
 Pinhead Manager.....✓NED BUTIKOFER
 London Policeman
 Will
 Lord John
 Whore.....✓ANNIE STAFFORD
 Pinhead
 Miss Sandwich
 Countess
 Princess Alexandra
 Mrs. Kendal.....✓SHARON BUNN
 Pinhead
 Orderly.....✓TOM FERSTLE
 Orderly.....✓PETER CHANNELL

John Merrick was a real person who spent the years from 1886 to his death in 1890 in the London Hospital, Whitechapel. His story has been told numerous times, in the memoirs of Frederick Treves (1923), in Ashley Montagu's "The Elephant Man" (1971), in Leslie Fiedler's "Freaks" (1978), and in Frederick Drimmer's "Very Special People" (1973). Photographs used in the production are photographs taken of Merrick at the hospital. The model of St. Philip's Church that Merrick constructed can be seen today in the London Hospital.

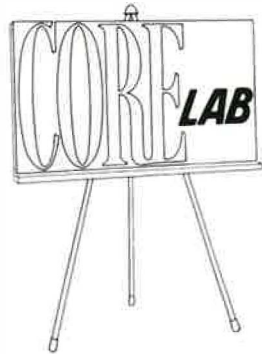

Now appearing
 in 59
 cities throughout
 the world

International Petroleum Engineering and Field Services

SETTING

1884-1890, London and Belgium

Scene 1 HE WILL HAVE 100 GUINEA FEES BEFORE HE'S FORTY
 Scene 2 ART IS AS NOTHING TO NATURE
 Scene 3 WHO HAS SEEN THE LIKE OF THIS?
 Scene 4 THIS INDECENCY MAY NOT CONTINUE
 Scene 5 POLICE SIDE WITH IMBECILES AGAINST THE CROWD
 Scene 6 EVEN ON THE NIGER AND CEYLON, NOT THIS
 Scene 7 THE ENGLISH PUBLIC WILL PAY FOR HIM TO BE LIKE US
 Scene 8 MERCY AND JUSTICE ELUDE OUR MINDS AND ACTIONS
 Scene 9 MOST IMPORTANT ARE WOMEN
 Scene 10 WHEN THE ILLUSION ENDS HE MUST KILL HIMSELF

10-MINUTE INTERMISSION

Scene 11 HE DOES IT WITH JUST ONE HAND
 Scene 12 WHO DOES HE REMIND YOU OF?
 Scene 13 ANXIETIES OF THE SWAMP
 Scene 14 INGRATITUDE
 Scene 15 ART IS PERMITTED BUT NATURE FORBIDDEN
 Scene 16 NO RELIABLE GENERAL ANESTHETIC HAS APPEARED YET
 Scene 17 CRUELTY IS AS NOTHING TO KINDNESS
 Scene 18 WE ARE DEALING WITH AN EPIDEMIC
 Scene 19 THEY CANNOT MAKE OUT WHAT HE IS SAYING
 Scene 20 THE WEIGHT OF DREAMS
 Scene 21 FINAL REPORT TO THE INVESTORS

RICHES TO RIVAL THE RAINBOW'S END.

There's a glow of treasures to be found at the Quadrangle. Especially for shoppers who seek the special, the unusual, the unexpected.

From homemade dips to worldwide trips, burnished antiques to splendid batiks, writing papers to perfumed tapers.

The Quadrangle. 47 specialty shops that are truly special. A golden opportunity for discriminating shoppers. And just minutes away.



IN THE SHADOW OF DOWNTOWN DALLAS.

HOURS: 10:00 AM-5:30 PM MON.-SAT. FREE PARKING

QUADRANGLE

2800 ROUTH STREET BETWEEN MCKINNEY & CEDAR SPRINGS/742-8679

WHO'S WHO IN THE CAST



JOHN STUART ANDERSON



SHARON BUNN



NED BUTIKOFER



PETER CHANNELL

*JOHN STUART ANDERSON (Carr Gomm, Conductor) has spent most of his career developing a series of solo performances. He made his Dallas debut several years ago in "The Gospel of John" and appeared last year in the premiere of the controversial "Act and Betrayal." Mr. Anderson was nominated for the Bay Area Critics Award (San Francisco) for "Picture of Dorian Gray" and has recorded "The Passion of Frankenstein" for Columbia. His play-for-two, "Lykos: The Danger in the Maze" has been selected for production at the Pasadena Playhouse in Pasadena, California. Mr. Anderson is now a permanent Dallas resident.

*SHARON BUNN (Mrs. Kendal, Pinhead) appeared in more than 25 Theatre Three productions during her five years here on our staff. Her club work includes touring on the Playboy Club Circuit. Miss Bunn has performed with the Los Angeles Actor's Theater, has done television, radio and films, and has recorded voices for the Six Flags Over Texas puppet shows. She has recently been living in Los Angeles and has written songs for the L.A. Slugs, a Los Angeles New Wave band. Miss Bunn's most recent Theatre Three appearance was this spring as Elaine Rutledge in the Second Stage Festival production, "The Miss Firecracker Contest."

NED BUTIKOFER (Pinhead Manager, London Policeman, Will, Lord John) was born and reared on a small farm in Utah and says he always wanted to be an actor. He holds a bachelor's degree in theatre from Weber State College, Ogden, Utah, and a master's in acting from Southern Methodist University. Among Mr. Butikofer's favorite roles are Floyd in "The Oldest Living Graduate," Ronald in "Absurd Person Singular," and Sir Oliver in "School for Scandal" at the Bob Hope Theatre in Dallas. "The Elephant Man" marks Mr. Butikofer's debut on the Theatre Three stage.

PETER CHANNELL (Orderly) had his first encounter with acting when he was a child in a school production of "Jack and the Beanstalk." An Australian now living in Dallas, Mr. Channell has appeared in numerous children's productions since then, including "Peter Pan."

*Member, Actors' Equity Association

He also has performed in "Fiddler on the Roof," "Mame," "Captain of Kopenich," and "Satyricon."

*VINCE DAVIS (John Merrick) has enjoyed a varied career as an actor since receiving his BFA from Southern Methodist University. He has toured the U.S. and Canada and has appeared locally in such roles as Ken Talley in "Fifth of July" and the wayward son Vince in "Buried Child" at Stage One. Mr. Davis' first role at Theatre Three was as Dr. Nakamura in "Happy End," and he was seen most recently on our stage as Mac Sam in "The Miss Firecracker Contest" and Paul in "Father Dreams," the two productions of this season's Second Stage Festival. In addition to his stage credits, Mr. Davis stays busy making commercials and industrial and television films.

TOM FERSTLE (Orderly) made his Theatre Three debut several seasons ago as Baby Face in "Happy End." A native of Toledo, Ohio, Mr. Ferstle graduated from St. John's High School in that city. While in Ohio, he appeared as John Proctor in "The Crucible" and as Puck in "A Midsummer Night's Dream." He has also performed in three shows for educational television.

*MIKE HARRELL (Ross, Bishop How, Snork) is a veteran of several Theatre Three productions, including "Canterbury Tales," "The Robber Bridegroom" and "Happy End." A drama/rhetoric major at North Texas State University, he also attended the American Conservatory Theater in San Francisco and was a resident member of the Firehouse Theater Company. Mr. Harrell's Dallas experience has included work with the Dallas Theater Center's Teen/Children's Theater.

*LAURENCE O'DWYER (Frederick Treves, Belgian Policeman) delighted audiences last fall as the engaging "Strider" in Theatre Three's season opener. His directorial credits this year are "Bedroom Farce," "The Miss Firecracker Contest," two children's theatre productions, "The Happy Prince" and "Seven Dancing Princesses," and "House of Flowers." Mr. O'Dwyer's numerous Theatre Three acting credits include "Otherwise Engaged," "Present Laughter," "Sleuth," and "Drinks Before Dinner." During a hiatus from Theatre Three in the mid-'70s, he served as Chairman of the Drama Department at Bennington College in Benning-

WHO'S WHO IN THE CAST



VINCE DAVIS



MIKE HARRELL



LAURENCE O'DWYER



ANNIE STAFFORD

ton, Vermont. Mr. O'Dwyer currently is on the staff here in charge of children's theatre productions.

*ANNIE STAFFORD (Pinhead, Whore, Miss Sandwich, Countess, Princess Alexandra) has appeared on our stage this season as Popeye in "The Miss Firecracker Contest" and Rachel Arbuthnot in "A Woman of No Importance." She has worked extensively in regional theatre, Off-Broadway, in dinner theatres and on tour. Recent performances elsewhere include Faye in "Chapter Two" and the dual roles of Pearl/Dot in "Patio/Porch." Her Theatre Three performances last season included Nina in "The Seagull" and Andrea in "Drinks Before Dinner."

BERNARD POMERANCE (Playwright) was born and raised in New York City and educated at the University of Chicago. His plays include "High in Vietnam" and "Hot Damn" (presented at London Polytechnic Festival, 1971, and the Almost Free Theatre, 1972), "Foco Novo" (Oval House, 1972), "Someone Else Is Still Someone" (London Bush Theatre, 1974) and an adaptation of Bertolt Brecht's "A Man's A Man" (London Hampstead Theatre, 1975). "The Elephant Man" premiered at the Hampstead Theatre in 1977 and on Broadway on April 19, 1979. For "The Elephant Man," Mr. Pomerance won the Tony Award, the New York Drama Critics Award, the Obie Award, the Drama Desk Award, and the Outer Critics Circle Award.

*CHARLES HOWARD (Director) has been Associate Director of Theatre Three since 1975. During that time he has served as primary set designer and has directed numerous productions on our stage. His favorite set designs include "Candide," "Yip, Yip, Hooray!" and "Sleuth," and he lists "Present Laughter," "A Woman of No Importance" and "Father Dreams" as his most enjoyable directorial assignments. Last fall Mr. Howard decided to learn how to type, and he now lists among his hobbies perfecting his typing skills.

PATTY GREER MCGARITY (Costumer) began her association with Theatre Three in 1965 and has since designed the costumes for well over a hundred productions. Educated at North Texas State University, Mrs. McGarity has lectured at Bauder College and El Centro

College. In 1972, she traveled to Vermont's Bennington College to serve as guest costumer for their production of "The School for Wives." Outside of her work at the theatre, Mrs. McGarity creates theatrical character dolls.

*SHARI MELDE (Lighting Designer), a native of Dallas, studied art at Trinity University and technical theatre at S.M.U. Her association with Theatre Three dates back to 1965 when she volunteered to assist in operating the lights for "Stop the World, I Want to Get Off!" Over the years Miss Melde has become one of the theatre's most valued lighting designers. Recent credits include "Father Dreams," "The Miss Firecracker Contest," "Bedroom Farce," "A Woman of No Importance," and "Strider." Currently she is continuing her studies at the University of Texas at Dallas.

PETER A. METZ (Set Designer) is a graduate of California State University with an MFA in theatrical design from Southern Methodist University. His credits in set design include the nationally televised "With Ossie and Ruby" series for KERA-TV, "Forgotten Memories" for the Dallas Ballet, "Carousel" and "Can-Can" for the Music Theatre of Wichita, and "The Belle of Amherst" for New Arts Theatre. Locally Mr. Metz has created the lighting design for numerous Six Flags Over Texas productions, as well as for Theatre Three's "How I Got That Story," for the national tour of "Porter, Please" and for the recent "House of Flowers."

*Member, Actors' Equity Association



CHARLES HOWARD

**"Say It With Music
By Irving Berlin"**

Onstage at Theatre Three
July 14 - August 22



We Add A New Dimension To Birthdays

2535 CEDAR SPRINGS
DALLAS, 75201

748-3903



*The State Of The Art
In North Dallas.*

NORTH PARK NATIONAL BANK

NORTH PARK CENTER, DALLAS, TEXAS 75225
(214) 363-9191
MEMBER NORTH PARK NATIONAL CORPORATION
MEMBER FDIC

**forward sportswear
&
haircutting
for men**

**UNION
JACK**

dallas • 3918 cedar springs • 528-9600
houston • 4025 westheimer • 622-3100
open monday through saturday, 10 to 7

**Rogers Electric
would like to
lighten your day.**

Visit our showroom and maybe
we can brighten your day.

We have some of the best values
in lighting along with one of the
most extensive selections. Add
our friendly folks and you have a
winning combination.

Lighten your day.

rogers electric
FIRST IN DISTINCTIVE LIGHTING SINCE 1990
5301 NORTH CENTRAL EXP. WY. AT MCCOMMAS
(214) 521-3117
A QUALITY COMPANY OF
SUMMERS ELECTRIC

Dining and Entertainment

BURGERS AND DRINKS

BALBOA CAFE — 3605 Oak Lawn (521-1068). The second Fern Bar to emerge in Dallas. This unique pub offers great food, excellent bartenders and a relaxed homey atmosphere. Offering a delicious Sunday Brunch! Open seven days a week, 11am-2am.

BLUE'S LAKEFRONT BAR AND GRILLE — 3407 W. Northwest Hwy. (351-6536). Fancy burgers, catfish and drinks, overlooking Bachman Lake. Open seven days till 11pm, midnight on weekends. Major credit cards.

THE GREENVILLE AVENUE COUNTRY CLUB — 3619 Greenville Ave. (826-5650). Serving a scrumptious assortment of burgers, sandwiches, and snacks. Enjoy the cozy atmosphere indoors or take your refreshments poolside and relax. Open Mon.-Sat., 11am-2am; Sun., 12pm-2am.

CONTINENTAL

CRACKERS — 2621 McKinney (827-1660). Charming atmosphere, good food and affordable prices are the trademarks of this notable addition to the booming McKinney "restaurant district". Lunch: Mon.-Fri. 11-2:30 pm, Sat. 11-3pm. Dinner: Mon.-Thur. 5-10pm., Fri.-Sat. 5-11pm. Sunday Brunch: 11-5pm. Sunday Dinner: 5-10pm.

THE GRAPE RESTAURANT — 2808 Greenville Ave. Intimate, candlelit bistro serving cheeses, pates, pasta, blackboard entrees, and over 150 wines. Full bar. Dinner every night, until 1am on weekends. Lunch M-F. MC, VISA, Am. Express.

PIERRE'S — 3430 Shorecrest (358-2379). Gourmet seafoods, steaks, appetizers, salads, wines and cocktails. Quiet, continental elegance in historic home overlooking Bachman Lake. Dinner M-Sat., luncheon M-F.

LE RENDEZ-VOUS — 3237 McKinney (745-1985). An intimate French Bistro serving lunch, dinner and a good amount of romance. Lunch: 11am. to 2pm, Mon.-Fri. Dinner: 6pm to 11pm, Mon.-Thurs., 5:30pm to 1am, Fri. Open 11am to 2am, Sat., Noon to 11pm Sunday.



2621 McKinney Ave.
827-1660

Dinner
Mon. — Thur. 5-10 p.m.
Fri. — Sat. 5-11 p.m.

A charming little restaurant with a reputation for serving good food at reasonable prices.

Happy Hour
4 p.m. to 7 p.m.

Lunch
Mon. — Fri. 11-2:30 p.m.
Sat. 11 — 3 p.m.

Sunday
Brunch 11-5 p.m.
Dinner 5-10 p.m.

HOME-COOKING

THE BLACK-EYED PEA — 3857 Cedar Springs or 4814 Greenville Ave. (521-4580 or 361-5979). Home of the world's finest chicken fried steak, terrific pork chops and fancy drinks. Open seven days till 11pm, midnight on weekends. Major credit cards.

THE DIXIE HOUSE — 2822 McKinney (824-0891). Pan-fried chicken, ham steak, meat loaf, catfish, vegetables, burgers, fresh breads. Open seven days till 11pm, midnight on weekends. Major credit cards.

THE DIXIE LAKEWOOD — 6400 Gaston Ave. (826-2412). More pan-fried chicken, meat loaf, ham steak, etc., in historic old east Dallas. Open seven days till 11pm, midnight on weekends. Major credit cards.

JAZZ/DINING

STRICTLY TABU — 4111 Lomo Alto (526-9325). Best pizza in Dallas. Homemade Lasagne, eggplant parmigiana and other Italian dishes. Featuring jazz groups such as Ed Hagan & Friends, Highrise, and Robert Sanders. Serving food until 12 nightly, music until 1:30am.

MEXICAN

TAMALES — 3205 Oak Lawn (526-2351). The best of Texas and Mexico — barbecue and comida Mexican. Open seven days till 11pm, midnight on weekends. Major credit cards.

SEAFOOD

CRAW-DADDY'S — 2614 McKinney (748-2008). Cajun-style cooking and seafood. Shrimp, oysters, fish, gumbo and more. Open seven days till 11pm, on weekends till midnight. Major credit cards.

WINE BAR

THE WINE PRESS — 4217 Oak Lawn (522-8720). Oak Lawn's finest wine bistro featuring an extensive list of wines and cheeses from around the world. Menu includes a varied selection of entrees, omelettes, and sandwiches. Open Mon.-Sat. 11-2am. Sun. Noon-2am.

SQUEEZE MORE OUT OF THE GRAPE.

On Friday and Saturday nights our full bar and complete menu stays open 'til 1:00 am. So after the theatre, join us at Dallas' original Bistro.

Because, when the encore's over, we'll continue to perform.

Serving lunch from 11:30 am to 2:00, Monday thru Friday.
Dinner daily from 6:00 pm to 11:00 pm.

2808 Greenville Ave

823-0133

HAND DELIVERY
NORBERT EWERS
ANGIE DEWALD

DIRECT MAILING
RUTHIE EWERS
LIZ LEONARD



DISTRIBUTING SERVICE INC.

4814 CASH RD
DALLAS TEXAS 75247

630.6941
263.5901

THEATRE THREE STAFF

Producer-Director Jac Alder
Associate Director Charles Howard
Associate Director Laurence O'Dwyer

ADMINISTRATIVE OFFICE

Producer's Assistant Nancy Akers
Publicity Director Terri Taylor
Comptroller William DeGnath

OFFICE OF DEVELOPMENT

Directors Howard Gold
Richard McKenzie

BOX OFFICE

Box Office Manager William DeGnath
Box Office Staff Camille Carrell
Samuel Cornelius
Dana Jackson
Chuck Morris
Annie Stafford
Rick Tankersley
House Managers Carmen Gonzalez
Steve Linville

PRODUCTION

Stage Manager Thom Schilling
Costumer Patty Greer McGarity
Stage Crew Bill Campbell
Bob Golibart
Dan Perry
Willie Wood

APPRENTICE PROGRAM

Membership Candidate Deborah Brooks
Membership Candidate Amy Mills

Tour Management by Bill Fegan Attractions

HOUSE RULES

The Fire Marshall prohibits smoking in the auditorium.

The House Manager prohibits refreshments in the auditorium.

The Stage Manager prohibits photographing or recording the performance.

Playgoers leaving their seats during the performance must be re-seated in available seating specified by the House Manager.

forward sportswear
&
haircutting
for men

UNION
JACK

dallas • 3918 cedar springs • 528-9600
houston • 4025 westheimer • 622-3100
open monday through saturday, 10 to 7

Open till
Midnight
on Weekends!

The finest in catfish, shrimp
& oysters this side of Louisiana!!

Craw-Daddy's

2614 McKinney
Dallas, Texas 75204
748-2008

If you're interested in Texas and serious about business, you should be reading **Texas Business**

Each month TEXAS BUSINESS brings you all the important facts and figures on people and companies doing business in Texas — from the two-man operations to the multi-national giants . . . the businessmen making it and those who already have . . . the politics and politicians. We cover business maneuvers, business indicators, business blunders and more . . . all in an interesting and award-winning style!

Try receiving TEXAS BUSINESS for 9 months at the low rate of only \$9.99 — that's 43% off the cover price. You'll find, as thousands of executives have found — that TEXAS BUSINESS is must reading for those interested in business in Texas.

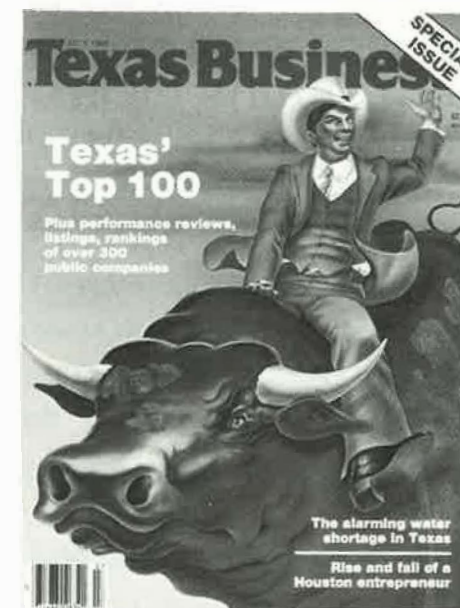

- ☐ YES! Send me 9 issues of TEXAS BUSINESS for only \$9.99.*
☐ Double my savings and send 18 months for \$18.88!.*
☐ Payment Enclosed ☐ Bill Me ☐ Bill My Company

Name _____
Position/Title _____
Company _____
Address _____
City/State/Zip _____

*Your subscription to TEXAS BUSINESS can be fully tax deductible.

ROCKWELL KNOWS THE IMPORTANCE OF A GOOD COMMUNITY.

That's why we encourage our employees to become active participants in community organizations.

Rockwell supports over 65 of these organizations locally through financial or personal involvement. Our employees serve on city councils, chambers of commerce and educational boards ... as Jaycees, Lions, Rotarians and Kiwanians ... as board members of symphony, theatre, ballet and opera groups ... and as church leaders.

We're working together today to make our community a better place tomorrow.



**Rockwell
International**

...where science gets down to business